

# Brass gland, MDW...H MDW...HM type

## FEATURES & BENEFITS

- popular brass glands with cap nut and polyamide insert with lamellas, M thread
- highest degree of protection - IP68 (factory-mounted O-ring)
- for indoor and outdoor use



## MECHANICAL DATA

<b>Material</b>	body: nickel-plated brass; sealing ring: neoprene; clamping insert: PA 6; o-ring: NBR
<b>Operating temperature [°C]</b>	-40 ÷ +100

## CERTIFICATES & STANDARDS

<b>IP degree of protection</b>	IP68
<b>Standards</b>	EN 50262; type A

## NOTE!

MDN Nuts are to be ordered separately.

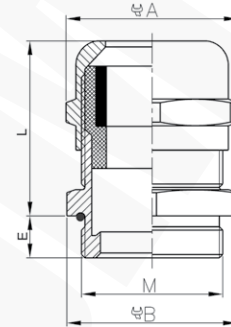

Type	Index Ergom	E	L	For spanner A	For spanner B	M thread	Cable external diameter [mm]	Quantity in package [pcs]
MDW 12HM (50 PCS)	E03DK-03070200101	6	24	14	14	M12x1,5	3+6,5	50
MDW 12HM (10 PCS)	E03DK-03070200103	6	24	14	14	M12x1,5	3+6,5	10
MDW 16HM (50 PCS)	E03DK-03070200201	7	26	17	18	M16x1,5	4+8	50
MDW 16HM (10 PCS)	E03DK-03070200203	7	26	17	18	M16x1,5	4+8	10
MDW 20HM (50 PCS)	E03DK-03070200301	8	28	22	22	M20x1,5	6+12	50
MDW 20HM (10 PCS)	E03DK-03070200303	8	28	22	22	M20x1,5	6+12	10
MDW 25HM (25 PCS)	E03DK-03070200401	8	32	24	27	M25x1,5	10+14	25
MDW 25HM (10 PCS)	E03DK-03070200403	8	32	24	27	M25x1,5	10+14	10
MDW 32HM (25 PCS)	E03DK-03070200501	9	35	30	34	M32x1,5	13+18	25
MDW 32HM (10 PCS)	E03DK-03070200503	9	35	30	34	M32x1,5	13+18	10
MDW 40HM (5 PCS)	E03DK-03070200601	9	45	40	43	M40x1,5	18+25	5
MDW 50HM (5 PCS)	E03DK-03070200701	9	50	50	55	M50x1,5	22+32	5
MDW 50HM	E03DK-03070200703	9	50	50	55	M50x1,5	22+32	1
MDW 63HM (5 PCS)	E03DK-03070200801	14	55	64	68	M63x1,5	34+44	5
MDW 63HM	E03DK-03070200803	14	55	64	68	M63x1,5	34+44	1

